

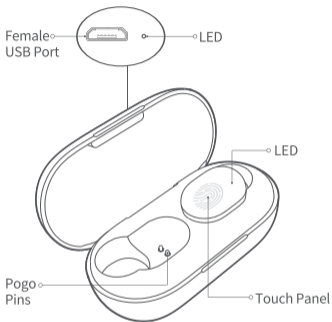

H A Y L O U

Haylou GT1 Plus
TWS Earphones
User Manual

Overview



What's in the Box

Earbuds, charging case, EarTips x 2 pairs, user manual, charging cable

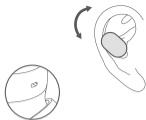

Please keep Mic
outside when calling



When calling, adjust Mic towards mouth to gain
better calling

How to Charge

Prior to using, please peel off sticker on the pogo pins
and top up the earbuds



Power-on

Take up earbuds from case to auto power on.
If earbuds are out of case, keep touching both panels for 2s to power on(LED glows solid white)



Power-off

Pop earbuds back into case to power off.
Keep touching panels for 4s to power off (LED glows solid red for 2s).



Ignore Call

Keep touching panel for 1s to ignore call.



Stereo Mode

Auto connection: take up both earbuds from the case. On cellphone, search for Haylou GT1 Plus R/L and tap to connect. Notice will show up on cellphone in 2s, tap to connect the other earbud.

If earphones fail to be connected to cellphone, please put earbuds back to the case and repeat the above steps. Earphones will auto reconnect to the last device in connectivity records, if any.

Note: earphones have been setted to factory when shipping out.

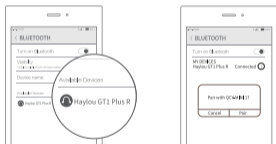

Manual pairing: manually power on two earbuds. On cellphone, search for Haylou GT1 Plus R/L when earbud blinks white slowly. Tap to connect.

Mono Mode

Auto pairing: take out one earbud from the case to power on it. Its LED will soon blink slowly then search for Haylou GT1 Plus R/L on cellphone and tap to connect. Once powering on, earbud will auto reconnect to last device in connectivity records, if any.

Manual pairing : manually power on one earbud. Its LED will soon blink white slowly then search for it on cellphone and tap to connect.

Basic Parameters

Operation range: 10m(with no obstacle)

Battery capacity: 43mAh(single EarBud)

Charging time: approx. 1.5hr

Calling time: approx. 3.5hr

Standby time: approx. 150hr

Input parameter: 5V= 100mA

Battery type: li-ion

Wireless connection: BT 5.0

Charging case

Input parameter:5V= 500mA

Output parameter:5V= 150mA

Charging time: approx. 2hr

Standby time: approx. 4 months

Battery capacity: 310mAh

Battery type: li-ion

Functions

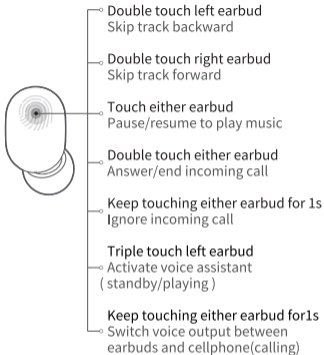

Switch Between Mono Mode and Stereo Mode

Take up both earbuds to enter stereo mode, put either earbud back to enter mono mode.

Daily maintenance

Please do not shower with earbuds. Do not wear them in rainy day. Do not leave them in washing machine or other extreme situations. Clean them with dry cloth after use in pursuing a longer service life.

Caveats

1. Please charge the product, in case it has not been used over two weeks.
2. Please use certificated charger.
3. Do not wear earphones for a long term to protect your hearing.
4. Do not wear earphones in any situations with potential risks as wearing them may reduce your perception to the outside world.

! Factory Setting

If earbuds do not function well, please refer the following step to reset factory: delete all connectivity records on cellphone.

Then take earbuds out from the case. Power off them, keep touching both earbuds for 10s or until LED blinks red and white for 3 times. Earbuds will be set to factory and power off. Manually power on earbuds and they will auto connect with each other (LEDs blink red and white promptly). GT1 PLUS will then enter pairing mode when left LED turns off and right LED blinks white slowly.

! Audio only outputs from single earbud

It's a rare case . Please reset the earphones, remove connectivity record on your cellphone and re-connect the earphones to your cellphone.

! Other problems in charging

LED glows solid white for 1 minute when earbuds are topped up.

Carry case will not charge earbuds, if its battery drains. LEDs on carry case will turn off once the case is topped up. If you charge it once again, LEDs will not give any notice, which does not mean the case is not charged.

Tips

1. Before using the headset, please read the manual carefully and keep it for future references.
2. The headset need to be fully charged prior to first-time use.
3. If the headset is left unused for over two weeks, please recharge it periodically.
4. Please use the chargers made by qualified manufacturer.
5. If the headset cannot be found by your phone, please check whether it is in pairing mode; if left unconnected for a long while, the headset will exit pairing mode, please re-enter the mode; if a procedure error of your phone occurs, reboot it; if a procedure error of the headset occurs, reboot or reset it.

Hazardous substances and their contents in the item



Part Name	Hazardous Substances									
	Pb	Hg	Cd	Cr (VI)	PBB	PBDE	DIBP	DEHP	DBP	BBP
Main body	X	○	○	○	○	○	○	○	○	○
Battery	○	○	○	○	○	○	○	○	○	○
Ear tips	○	○	○	○	○	○	○	○	○	○
Accessories	○	○	○	○	○	○	○	○	○	○
Charging cable	X	○	○	○	○	○	○	○	○	○

This form is made by SJ/T 11364 regulation.

O: means that hazardous substance content in the homogeneous materials of this part is within the limits of (EU) 2015/863 regulation .

X: means that hazardous substance content in ,at least, one certain homogeneous material of this part is beyond the limits of (EU) 2015/863 regulation ,but there is no mature alternative in the industry at present, it still conforms to the EU ROHS Directive in the scope of exemption.

Notes: Please arrange using time properly as your hearing may be damaged by using the device for a long time.

Aftersales & Support

Warranty Period:

12 months after purchase

(please keep your receipt properly)

Free Service:

If any quality defects happen during the warranty period, please take the receipt and contact with your distributor for aftersales service.

Following cases or any damages/defects that are not due to quality issue are not covered in the warranty.

1. Any defects or damages caused by natural disasters, abnormal voltage or other environmental facts.
2. Any unauthorized disassembly, modification or change of parts.
3. Any damages caused by improper use of the product including soaking, corroding, falling down, squeezing or exposure to abnormal temperature or humidity.

Model Number:
Date of Purchasing:
User's Name:
User's Phone:
User's Address:
Shop's Name:
Shop's Address:
Comments:

Address: Suite 1303, 1305 and 1306, 13/F, Project Phrase 2 of Gaosheng Tech Tower, Gaosheng Tech Park, No.5 Longxi Road, Zhouxi Community, Nancheng District, Dongguan City, Guangdong, China.

Manufacturer: Dongguan Liesheng Electronic Co., Ltd.

Web: www.haylou.com

Made In China