

tedee

INSTALLATION GUIDE AND USER MANUAL

GERDA SLR Modular Cylinder
TYPE C (cam, 30-61mm / 37-68mm)
and TYPE D (gear cam, 30-61mm / 37-68mm)

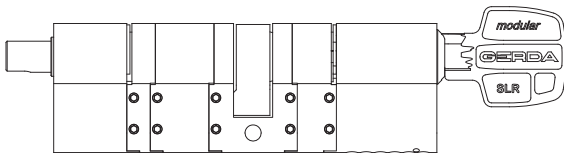

Read installation guide and user manual
and learn how to assemble the cylinder in a safe and proper manner.

table of contents

■ table of contents	Page 2
■ quick start with GERDA cylinder	Page 3
■ set of items – what’s in the box?	Page 4
■ what’s NOT in the box (but is needed)?	Page 6
■ code card	Page 7
■ setup - 3 easy steps	Page 8
■ step 1: PREPARE your door and MEASURE old cylinder	Page 8
■ step 2: ADJUST your cylinder	Page 15
■ step 3: INSTALL your cylinder	Page 19
■ final check	Page 21
■ additional and technical information	Page 23
■ technical information	Page 23
■ technical support	Page 24

quick start with GERDA cylinder

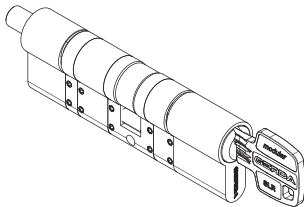

GERDA SLR Modular Cylinder can be fitted to any door, equipped with a lock that works with the euro-profile cylinders.

It's a part of tedee set. It's customized for tedee lock to make your door smart. It also works with traditional keys.

This booklet will give you an overview of the basic features of GERDA cylinder and will help you walk through the setup in 3 easy steps.

GERDA cylinder setup - go to page 8

3 easy steps

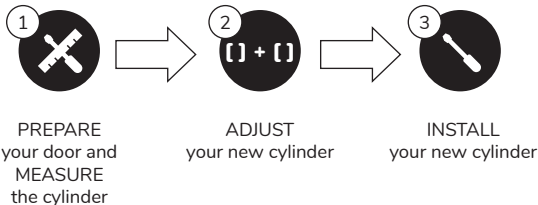

set of items – what's in the box?

GERDA SLR Modular Cylinder

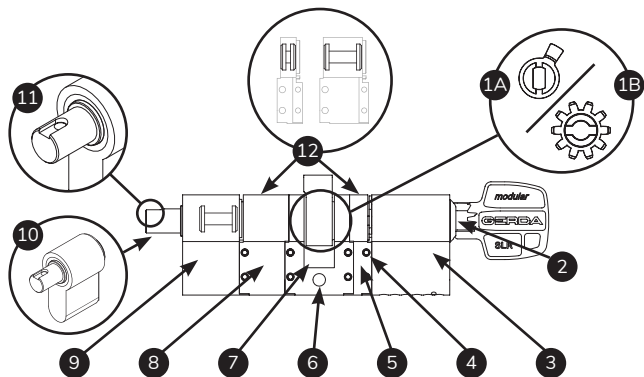

1A. Cam

1B. Gear

2. Keyhole

3. Key module

4. Clamping screws (x16)

5. Spacer [6mm]

6. Mounting screw socket

7. Cam/Gear module

8. Spacer [15mm]

9. Shaft module

10. Cylinder shaft

11. Groove and hole in cylinder shaft

12. Spacer spools [6mm, 15mm]



Note: Spacer spools are located inside all spacers and the shaft module, and are not visible unless you disassemble the cylinder.

set of items – what's in the box?

installation accessories and other items

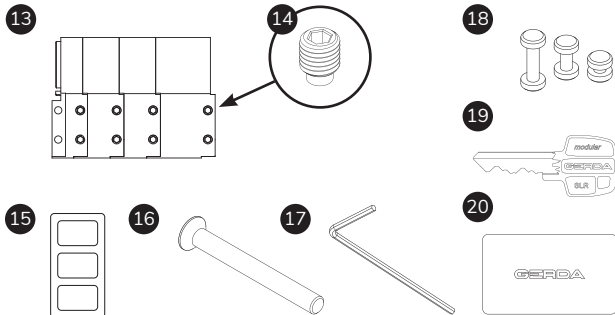

13. Spacers [6, 10, 10, 15mm]

14. Clamping screws (x16)

15. Sticker (x3)

16. Mounting screw

M5x80mm

17. Allen key (size 1.5)

18. Spacer spools [6mm,

10mm, 10mm, 15mm]

19. Keys (x3)

20. Code card



Note: Spacer spools are located inside all spacers and may fall out when you pick them from the box.

what's NOT in the box (but is needed)?

necessary to prepare



PHILLIPS SCREWDRIVER

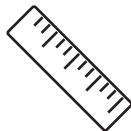

RULER



TIME (15-30 MIN)

code card

In case you need additional keys, you should use the key code from the code card.

You can order extra keys at orders@igerda.com

Helpful tip

Take a photo of your code card and keep it.

Location of the unique key code

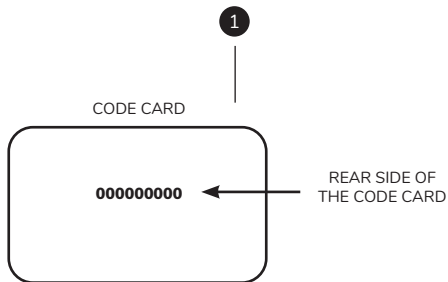

setup - 3 easy steps

step 1: PREPARE your door and MEASURE old cylinder

- 1 Please check, how much your cylinder sticks out from the lock escutcheon (from the inside of your apartment).

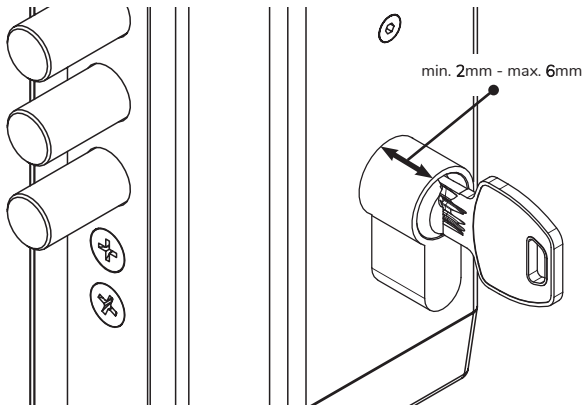

Note: If it's less than 2mm you should add extra length to your cylinder from the inside when you assemble it. If it's more than 6mm you should assemble a shorter cylinder from the inside to keep 2-6mm.

setup - 3 easy steps

- 2 Remove the mounting screw that keeps your old cylinder inside the door lock.

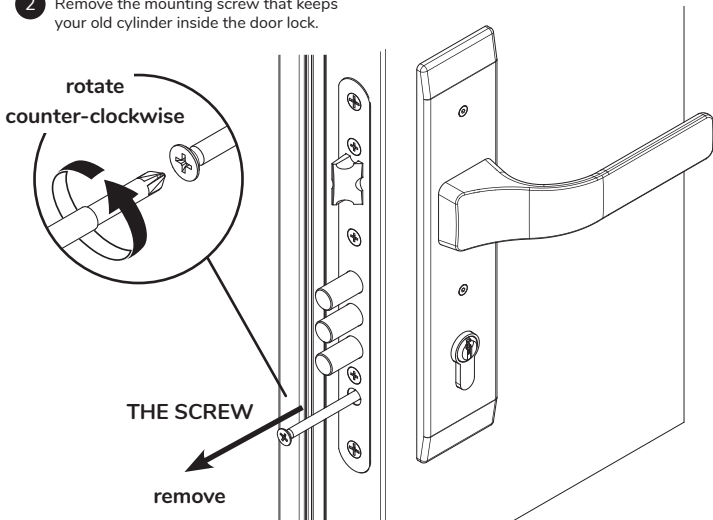

setup - 3 easy steps

- 3 In order to remove the old cylinder you may need to insert and turn the key to hide the cam. Try to pull the cylinder gently with the key inside to find the right position when the cam is hidden inside the cylinder.

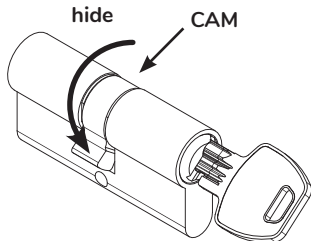

- 4 Remove the old cylinder from the door lock.

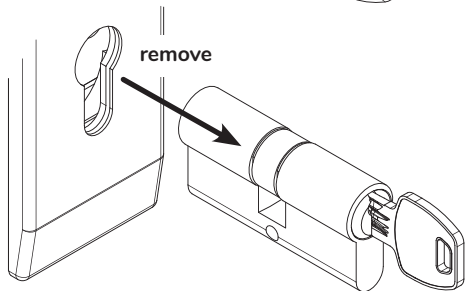

Note: If you have a high security door with a reinforced lock escutcheon, you should disassemble the escutcheon first. You will find further instructions at tedee.com

setup - 3 easy steps

- 5 To properly assemble your new GERDA modular cylinder, you need to measure the old one.

your old cylinder

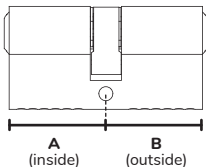

GERDA SLR Modular Cylinder

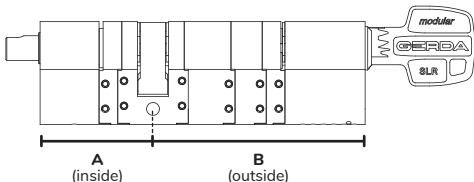

Note: You need to assemble GERDA SLR Modular Cylinder to match your old cylinder from the key side (outside) as close as possible.

setup - 3 easy steps

a handful of useful information before you start adjusting the size of your new GERDA SLR Modular Cylinder

Here is the minimum and maximum size of your GERDA SLR Modular Cylinder after you remove or add all extra spacers.

GERDA SLR Modular Cylinder - minimum size

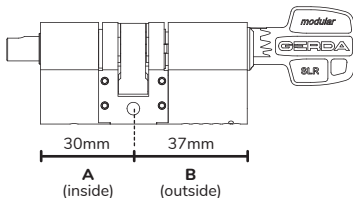

GERDA SLR Modular Cylinder - maximum size

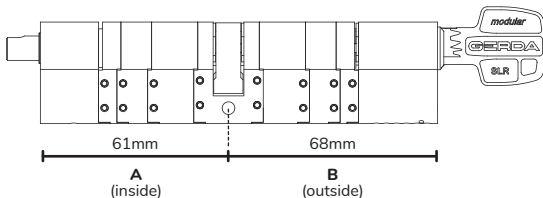

setup - 3 easy steps

Please check the table below for all possible combinations.

GERDA SLR Modular Cylinder

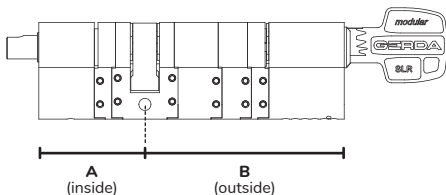

SIZE A (inside)	SIZE B (outside)
30mm (no spacers)	37mm (no spacers)
36mm (1 x 6mm)	43mm (1 x 6mm)
40mm (1 x 10mm)	47mm (1 x 10mm)
45mm (1 x 15mm)	52mm (1 x 15mm)
46mm (1 x 6mm + 1 x 10mm)	53mm (1 x 6mm + 1 x 10mm)
51mm (1 x 6mm + 1 x 15mm)	58mm (1 x 6mm + 1 x 15mm)
55mm (1 x 10mm + 1 x 15mm)	62mm (1 x 10mm + 1 x 15mm)
61mm (1 x 6mm + 1 x 10mm + 1 x 15mm)	68mm (1 x 6mm + 1 x 10mm + 1 x 15mm)

setup - 3 easy steps

spools and spacers sizes in 1:1 scale

If you need to check the spacer or the spool size, you may use the templates below.

SPOOLS

6mm



10mm



15mm

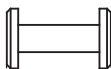

SPACERS

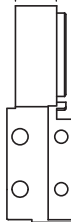

6mm

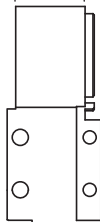

10mm

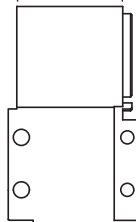

15mm



Note: While assembling the cylinder, remember to insert the spools inside the spacers (matching each other).

setup - 3 easy steps

step 2: ADJUST your cylinder

In order to adjust your GERDA SLR Modular Cylinder, add or remove spacers:

- 1 To detach a spacer, you need to remove the clamping screws from both sides using Allen key (size 1.5, included). Rotate the key counter-clockwise.

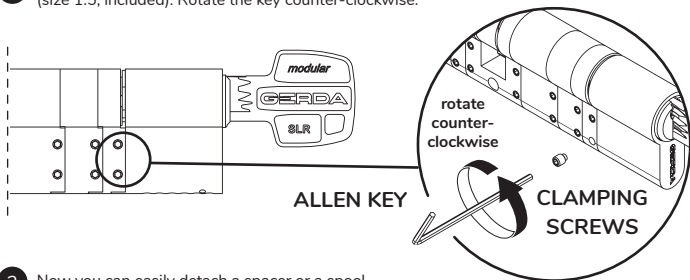

- 2 Now you can easily detach a spacer or a spool. Watch out for the loose spools inside.

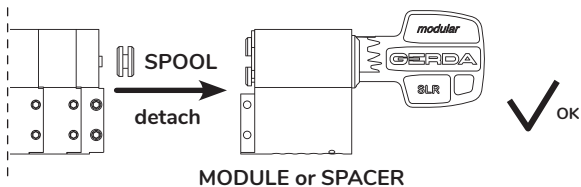

setup - 3 easy steps

- 3 If you want to add a spacer, just join one with another. Remember to insert a matching spool inside the spacer. Match too parts carefully – the rotation angle needs to be the same.

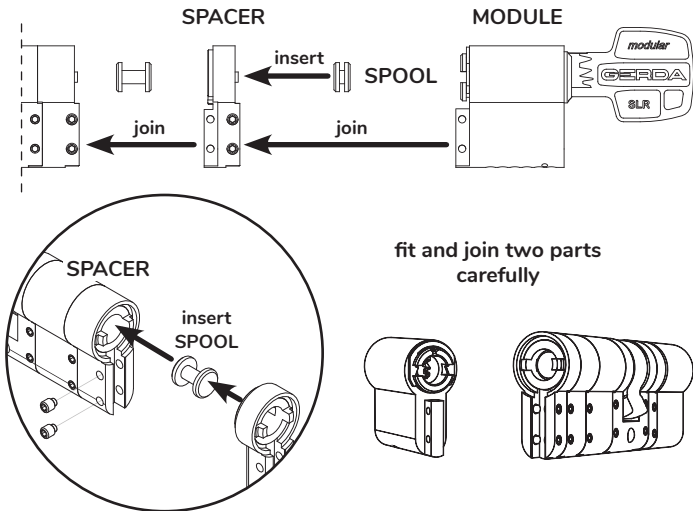

setup - 3 easy steps

- 4 After you successfully combine the spacers, spools and modules, you should fix the cylinder with clamping screws using Allen key. Rotate the Allen key clockwise until it stops.

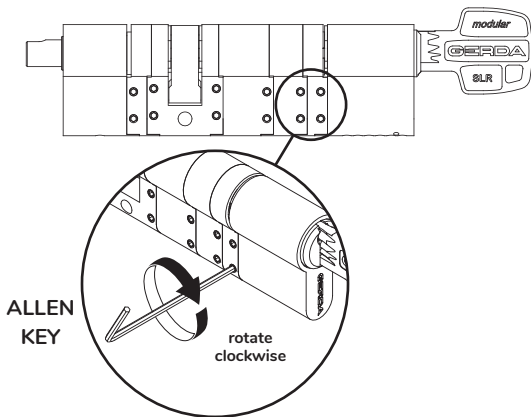

Note: Remember to fix the clamping screws from both sides.

setup - 3 easy steps

- 5 Make sure that your newly assembled GERDA SLR Modular Cylinder matches your old cylinder from the key side. You need to leave some extra length from the lock side (from the inside of your apartment) to make sure that the cylinder sticks out 2 to 6mm from the lock escutcheon.

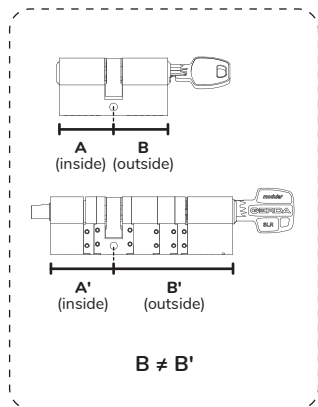
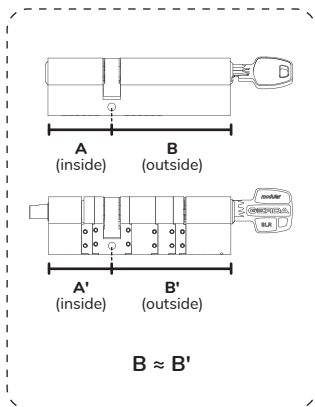

setup - 3 easy steps

step 3: **INSTAL** your cylinder

- 1 Insert your GERDA SLR Modular Cylinder into the door lock.

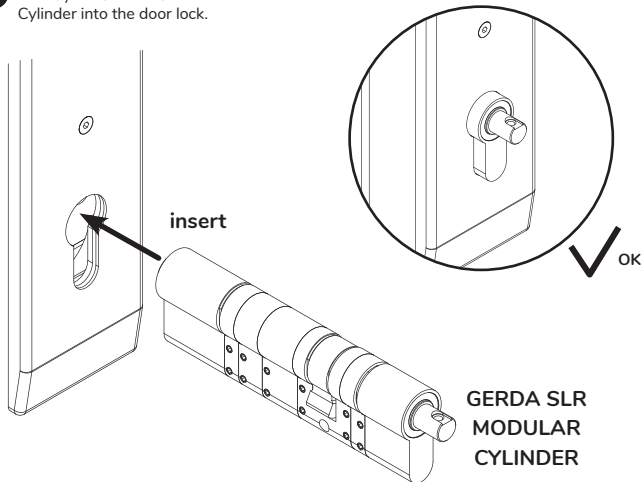

setup - 3 easy steps

- 2 Fix the mounting screw to install the cylinder in the door lock.

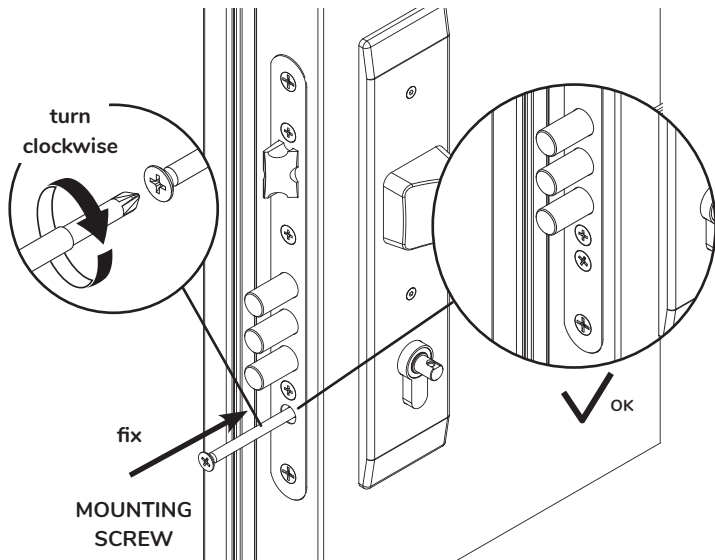

final check

- 1 Make sure that the cylinder sticks out from the door escutcheon (from the inside of your apartment) between 2-6mm. If it's less than 2mm or more than 6mm, go back to Step 2 and adjust its length accordingly.
- 2 If you want to muffle the sound, use the sticker as shown in the picture.

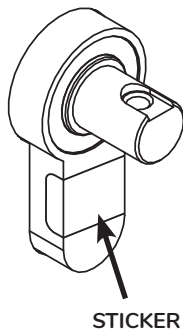
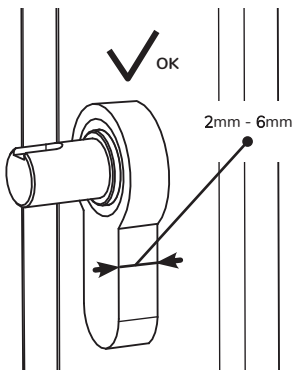

final check

- 3 Insert one of the keys into the keyhole (from the outside of the apartment) and rotate it left and right until it stops. If the bolts work correctly, you're good to go!

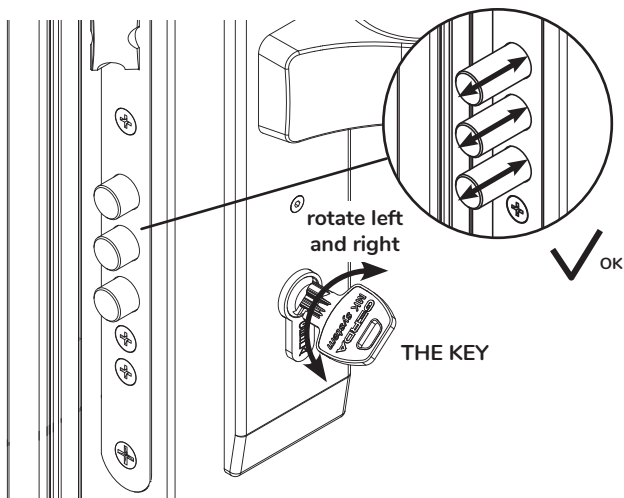

Continue with **tedee lock user manual** to see what to do next to smarten up your door.

additional and technical information

technical information

GERDA SLR Modular Cylinder

Models	Type C [cam, 30-61mm / 37-68mm], Type D [gear cam, 30-61mm / 37-68mm]
Category	Euro profile cylinder
Variants	cam or gear cam
Manufacturer	GERDA Sp. z o.o. ul. Sokołowska 49, 05-806 Komorów, POLAND +48 (22) 329 10 30, www.gerda.pl

declared performances

Category	1
Endurance	6
Door mass	0
Fire resistance	0
Safety	0
Corosion and temperature resistance	C
Key safety features	6
Attack resistance	D

technical support



For technical support please contact our support team



support@tedee.com



www.tedee.com/support



(+48) 884 088 011
Mon-Fri 8am – 4pm (CET)

tedee

Tedee Sp. z o.o. | Bohdanowicza 21/57, 02-127 Warsaw, POLAND
www.tedee.com | support@tedee.com